

- 1. Red (Mar:1050)
- 2. Ecru (Mar:1127)
- 3. Light Orange (Mar:1042)
- 4. Light Blue (Mar:1247)
- 5. Gold (Mar:1012)

Hardanger-1-5x7.art
 5.09x5.09 inches; 11,121 stitches
 5 thread changes; 5 colors

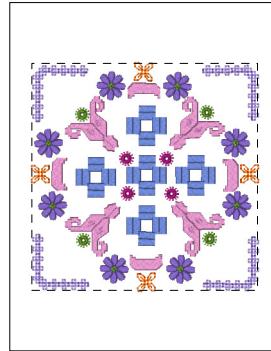

- 1. Red (Mar:1050)
- 2. Light Blue (Mar:1247)
- 3. Purplish-Pink (Mar:1239)
- 4. Orange-Red (Mar:1045)
- 5. Violet (Mar:1263)
- 6. Green (Mar:1284)
- 7. Magenta (Mar:1153)

Hardanger-2-5x7.art
 5.11x5.13 inches; 11,438 stitches
 7 thread changes; 7 colors

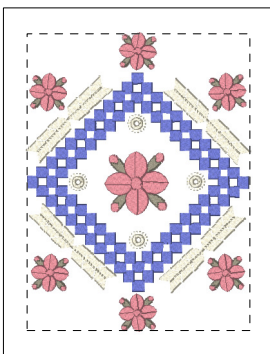

- 1. Light Blue (Mar:1248)
- 2. Dusty Rose (Mar:1035)
- 3. Olive (Mar:1330)
- 4. Dusty Rose (Mar:1035)
- 5. Light Yellow (Mar:1002)

Hardanger-3-5x7.art
 5.04x6.71 inches; 16,074 stitches
 5 thread changes; 4 colors

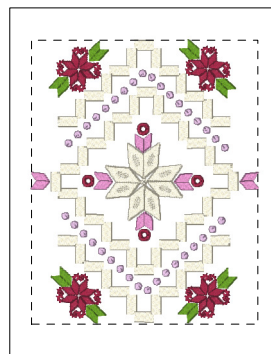

- 1. Light Yellow (Mar:1002)
- 2. Mauve (Mar:1074)
- 3. Purplish-Pink (Mar:1239)
- 4. Rose (Mar:1459)
- 5. Green (Mar:1284)

Hardanger-4-5x7.art
 5.11x6.42 inches; 14,657 stitches
 5 thread changes; 5 colors

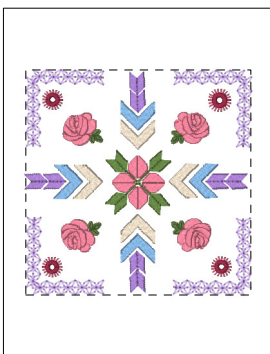

- 1. Ecru (Mar:1127)
- 2. Palm Green (Mar:1172)
- 3. Pink (Mar:1034)
- 4. Light Blue (Mar:1058)
- 5. Orchid (Mar:1081)
- 6. Rose (Mar:1459)

Hardanger-5-5x7.art
 5.09x5.09 inches; 9,134 stitches
 6 thread changes; 6 colors

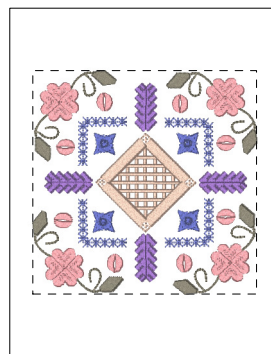

- 1. Red (Mar:1050)
- 2. Peach (Mar:1039)
- 3. Orchid (Mar:1081)
- 4. Leaf Green (Mar:1173)
- 5. Coral Pink (Mar:1234)
- 6. Light Blue (Mar:1248)

Hardanger-6-5x7.art
 5.06x5.06 inches; 15,007 stitches
 6 thread changes; 6 colors

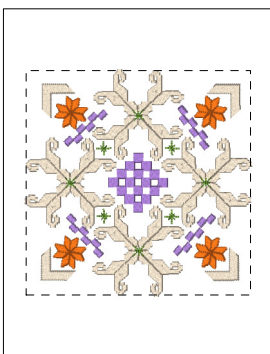

- 1. Ecru (Mar:1127)
- 2. Orange-Red (Mar:1045)
- 3. Green (Mar:1284)
- 4. Orchid (Mar:1081)

Hardanger-7-5x7.art
 5.07x5.07 inches; 12,539 stitches
 4 thread changes; 4 colors

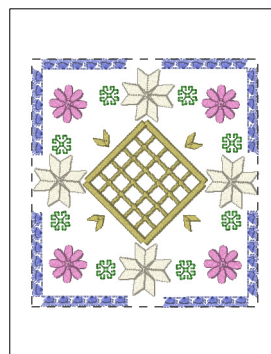

- 1. Red (Mar:1050)
- 2. Antique Gold (Mar:1016)
- 3. Light Yellow (Mar:1002)
- 4. Purplish-Pink (Mar:1239)
- 5. Green (Mar:1126)
- 6. Light Blue (Mar:1248)

Hardanger-8-5x7.art
 5.11x5.60 inches; 14,916 stitches
 6 thread changes; 6 colors