

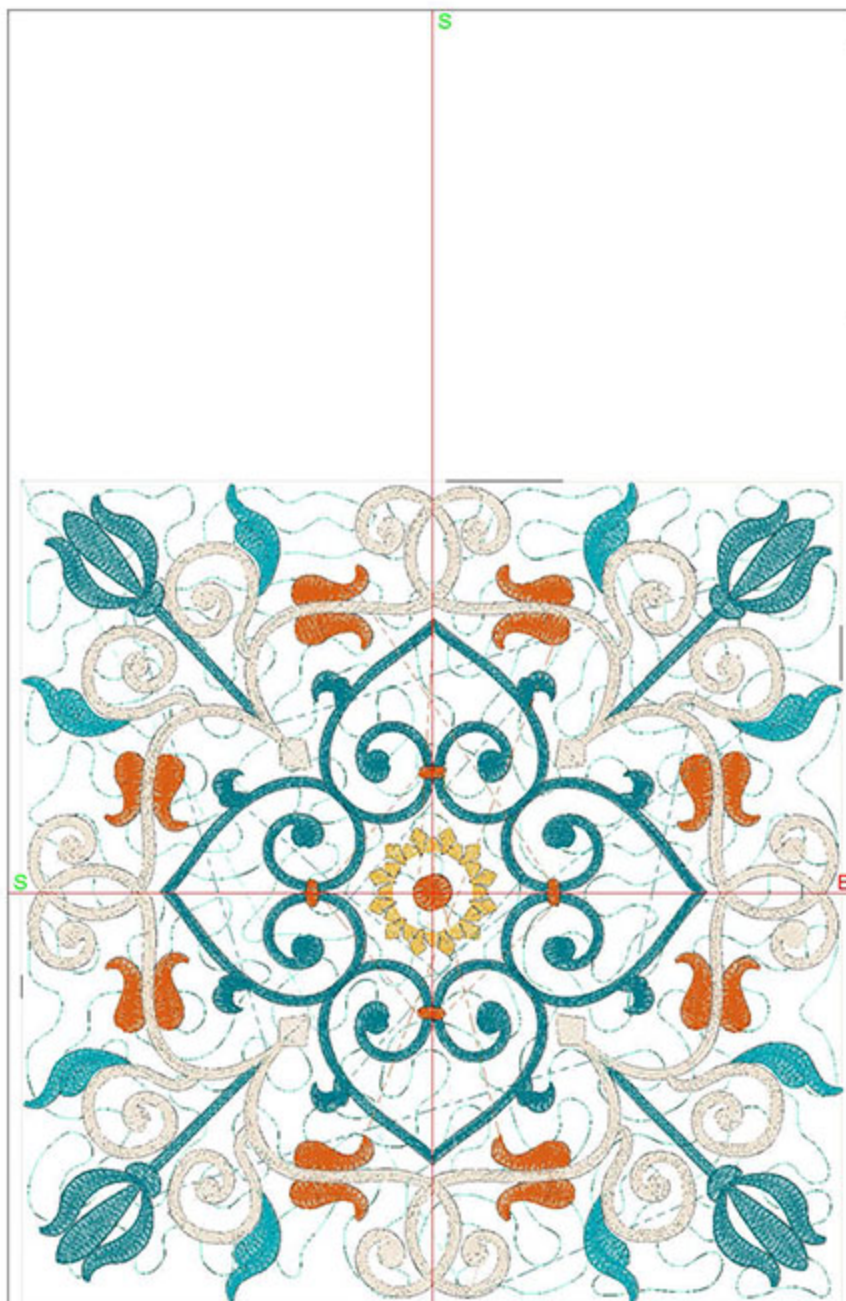

Design Worksheet

Zoom: 0.61

BERNINA Embroidery  
Software DesignerPlus



Name: MTQBlock1\_8x8.ART

Height: 200.7 mm  
 Width: 200.0 mm  
 Stitches: 40288  
 Colors: 6  
 Color changes: 6  
 Trims: 50  
 Machine format: Bernina  
 Hoop: Designer Royal (360 x 200)  
 Total bobbin: 87.23m

Color Sequence:

| #  | Color | Code | Name                 | Chart            |
|----|-------|------|----------------------|------------------|
| 1. | 1     | 1682 | Tusk                 | Madeira Polyneon |
| 2. | 17    | 17   | Turquoise            | Default          |
| 3. | 5     | 1890 | Midnight Green       | Madeira Polyneon |
| 4. | 2     | 1621 | Rust                 | Madeira Polyneon |
| 5. | 6     | 1771 | Whipped Butterscotch | Madeira Polyneon |
| 6. | 4     | 1888 | Deep Sky Blue        | Madeira Polyneon |
| 7. | 1     | 1682 | Tusk                 | Madeira Polyneon |

Machine runtime:

| Module  | Runtime (hr:min:sec) |
|---------|----------------------|
| Default | 1:42:21              |



Design Worksheet

Zoom: 0.61

BERNINA Embroidery  
Software DesignerPlus



Name: MTQBlock3\_8x8.ART

Height: 200.5 mm  
Width: 200.0 mm  
Stitches: 40571  
Colors: 6  
Color changes: 5  
Trims: 29  
Machine format: Bernina  
Hoop: Designer Royal (360 x 200)  
Total bobbin: 87.31m

Color Sequence:

| #  | Color | Code | Name                 | Chart            |
|----|-------|------|----------------------|------------------|
| 1. | 3     | 1682 | Tusk                 | Madeira Polyneon |
| 2. | 17    | 17   | Turquoise            | Default          |
| 3. | 7     | 1890 | Midnight Green       | Madeira Polyneon |
| 4. | 4     | 1621 | Rust                 | Madeira Polyneon |
| 5. | 6     | 1858 | Chestnut             | Madeira Polyneon |
| 6. | 8     | 1771 | Whipped Butterscotch | Madeira Polyneon |

Machine runtime:

| Module  | Runtime (hr:min:sec) |
|---------|----------------------|
| Default | 1:37:50              |



Design Worksheet

Zoom: 0.61

BERNINA Embroidery  
Software DesignerPlus

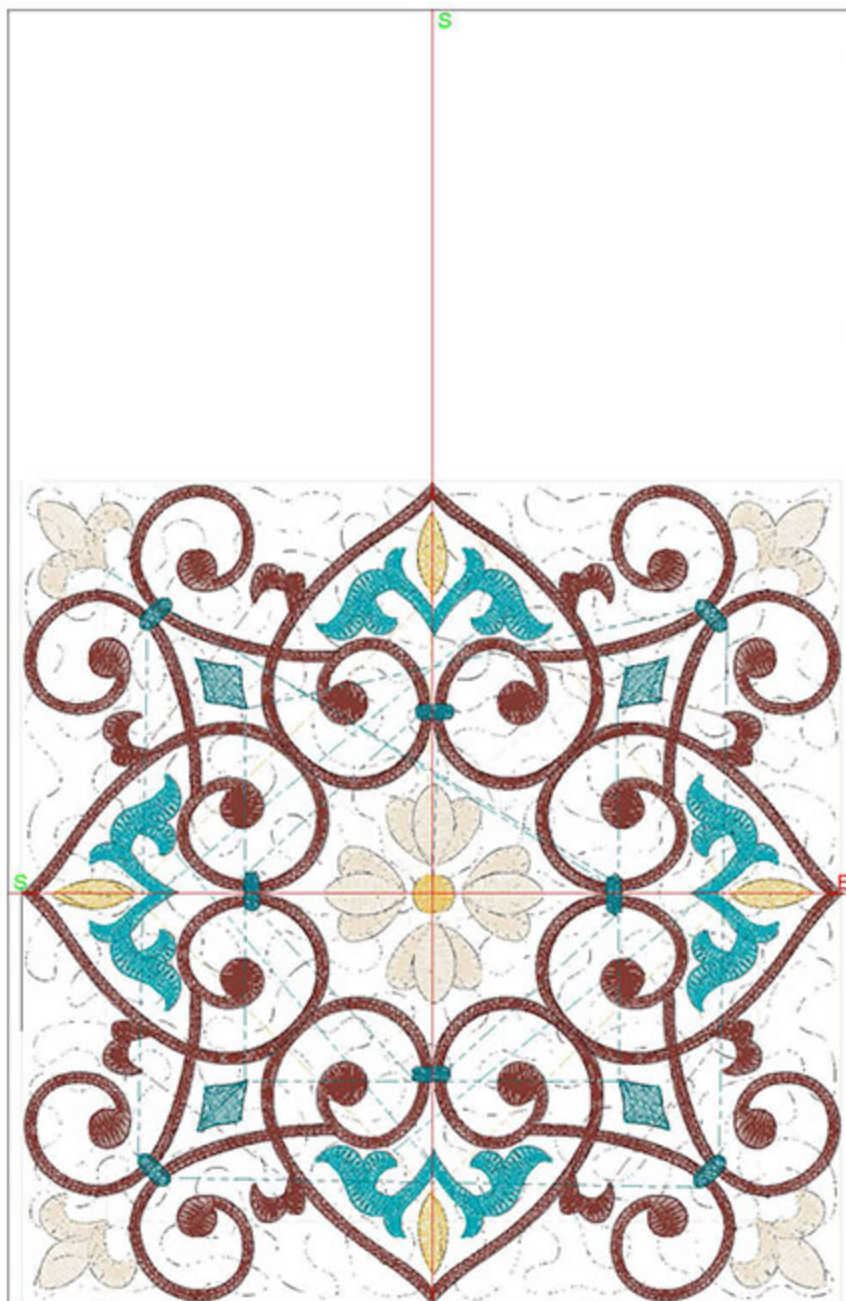

Name: MTQBlock4\_8x8.ART

Height: 200.7 mm  
 Width: 199.8 mm  
 Stitches: 35660  
 Colors: 6  
 Color changes: 6  
 Trims: 38  
 Machine format: Bernina  
 Hoop: Designer Royal (360 x 200)  
 Total bobbin: 81.71m

Color Sequence:

| #  | Color | Code | Name                 | Chart            |
|----|-------|------|----------------------|------------------|
| 1. | 1     | 1682 | Tusk                 | Madeira Polyneon |
| 2. | 9     | 9    | White                | Default          |
| 3. | 3     | 1771 | Whipped Butterscotch | Madeira Polyneon |
| 4. | 1     | 1682 | Tusk                 | Madeira Polyneon |
| 5. | 4     | 1888 | Deep Sky Blue        | Madeira Polyneon |
| 6. | 6     | 1858 | Chestnut             | Madeira Polyneon |
| 7. | 5     | 1890 | Midnight Green       | Madeira Polyneon |

Machine runtime:

| Module  | Runtime (hr:min:sec) |
|---------|----------------------|
| Default | 1:29:12              |



Design Worksheet

Zoom: 0.61

BERNINA Embroidery  
Software DesignerPlus

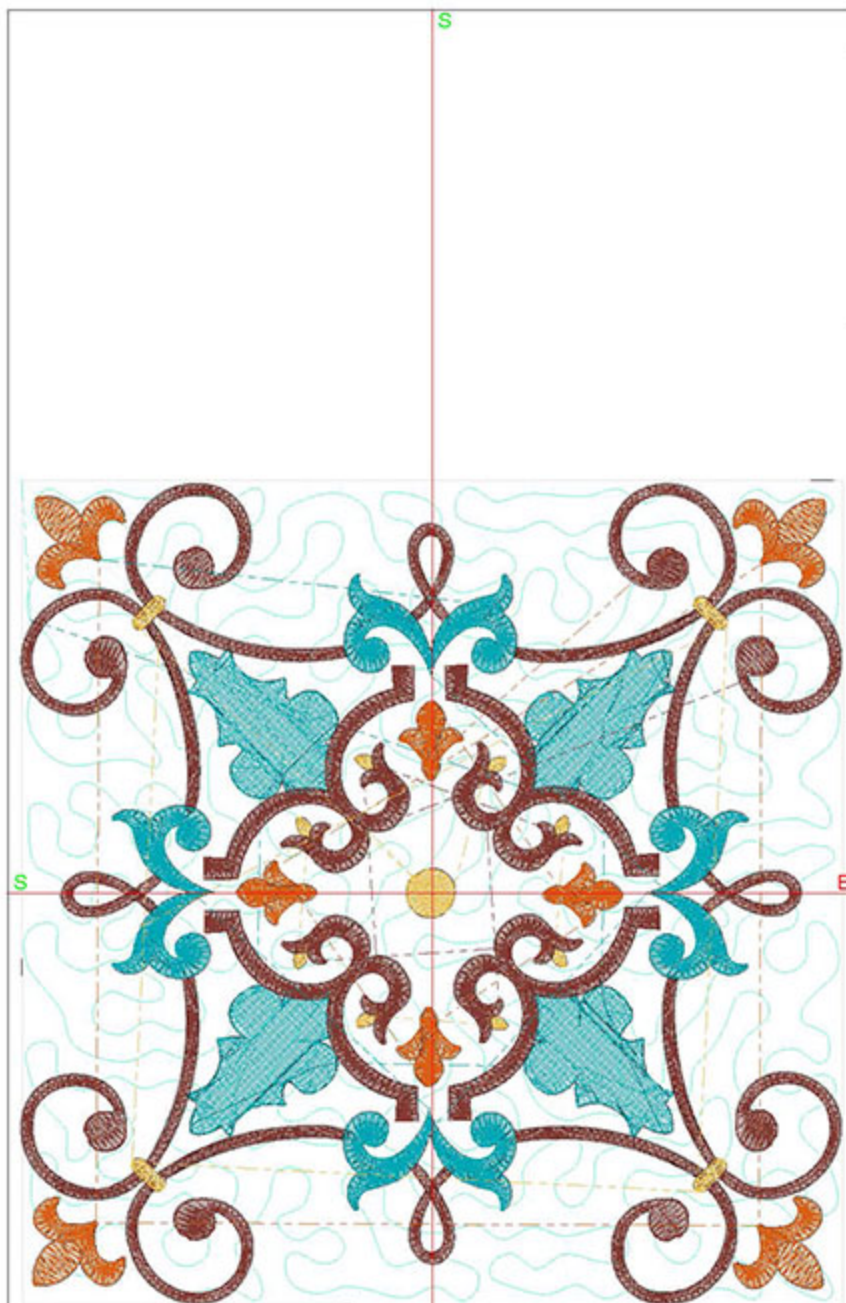

Name: MTQBlock5\_8x8.ART

Height: 200.7 mm  
 Width: 199.6 mm  
 Stitches: 33339  
 Colors: 6  
 Color changes: 7  
 Trims: 31  
 Machine format: Bernina  
 Hoop: Designer Royal (360 x 200)  
 Total bobbin: 79.08m

Color Sequence:

| #  | Color | Code | Name                 | Chart            |
|----|-------|------|----------------------|------------------|
| 1. | 1     | 1682 | Tusk                 | Madeira Polyneon |
| 2. | 17    | 17   | Turquoise            | Default          |
| 3. | 5     | 1888 | Deep Sky Blue        | Madeira Polyneon |
| 4. | 4     | 1771 | Whipped Butterscotch | Madeira Polyneon |
| 5. | 3     | 1858 | Chestnut             | Madeira Polyneon |
| 6. | 2     | 1621 | Rust                 | Madeira Polyneon |
| 7. | 5     | 1888 | Deep Sky Blue        | Madeira Polyneon |
| 8. | 4     | 1771 | Whipped Butterscotch | Madeira Polyneon |

Machine runtime:

| Module  | Runtime (hr:min:sec) |
|---------|----------------------|
| Default | 1:22:31              |



Design Worksheet

Zoom: 1.28

BERNINA Embroidery  
Software DesignerPlus

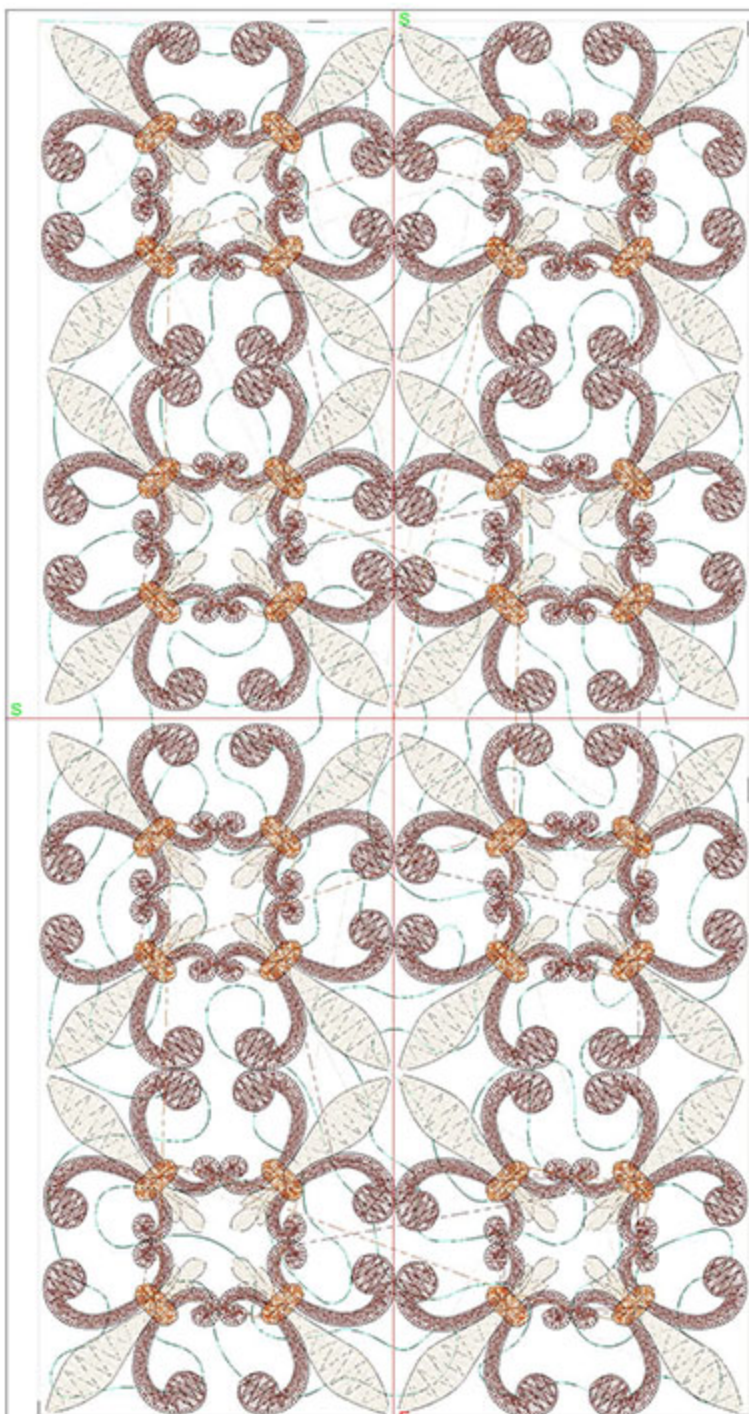

Name: MTQBlock6\_8x8.ART

Height: 200.2 mm  
Width: 101.9 mm  
Stitches: 36409  
Colors: 4  
Color changes: 4  
Trims: 112  
Machine format: Bernina  
Hoop: Designer Royal (360 x 200)  
Total bobbin: 63.53m

Color Sequence:

| #  | Color | Code | Name      | Chart            |
|----|-------|------|-----------|------------------|
| 1. | 1     | 1682 | Tusk      | Madeira Polyneon |
| 2. | 17    | 17   | Turquoise | Default          |
| 3. | 1     | 1682 | Tusk      | Madeira Polyneon |
| 4. | 4     | 1858 | Chestnut  | Madeira Polyneon |
| 5. | 6     | 1621 | Rust      | Madeira Polyneon |

Machine runtime:

| Module  | Runtime (hr:min:sec) |
|---------|----------------------|
| Default | 1:48:14              |



Design Worksheet

Zoom: 1.30

BERNINA Embroidery  
Software DesignerPlus

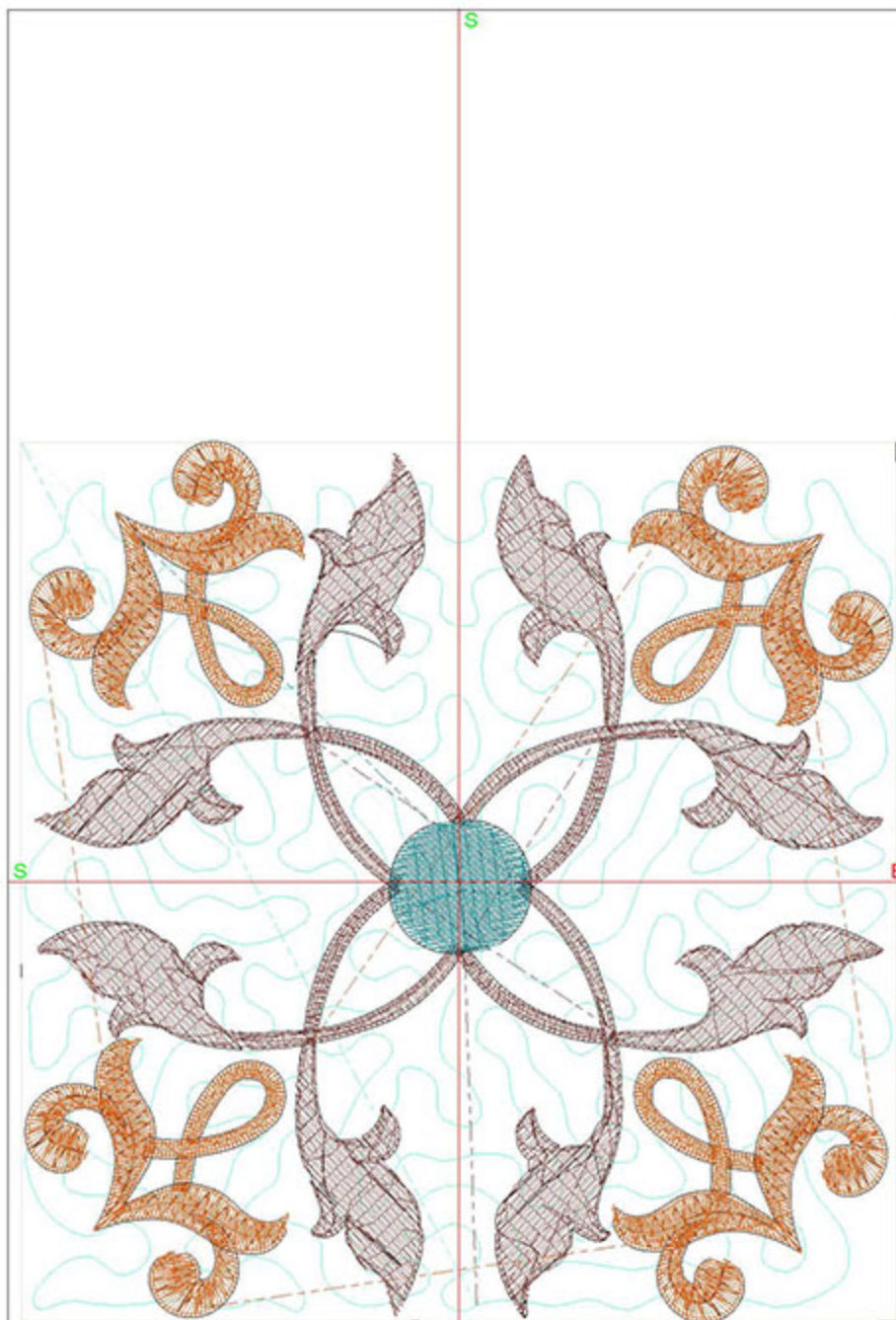

Name: MTQBlock7\_4x4.ART

Height: 101.0 mm  
Width: 100.5 mm  
Stitches: 11417  
Colors: 5  
Color changes: 4  
Trims: 18  
Machine format: Bernina  
Hoop: Designer Royal (360 x 200)  
Total bobbin: 19.95m

Color Sequence:

| #  | Color | Code | Name           | Chart            |
|----|-------|------|----------------|------------------|
| 1. | 1     | 1682 | Tusk           | Madeira Polyneon |
| 2. | 17    | 17   | Turquoise      | Default          |
| 3. | 7     | 1858 | Chestnut       | Madeira Polyneon |
| 4. | 2     | 1621 | Rust           | Madeira Polyneon |
| 5. | 4     | 1890 | Midnight Green | Madeira Polyneon |

Machine runtime:

| Module  | Runtime (hr:min:sec) |
|---------|----------------------|
| Default | 0:30:18              |



Design Worksheet

Zoom: 0.61

BERNINA Embroidery  
Software DesignerPlus

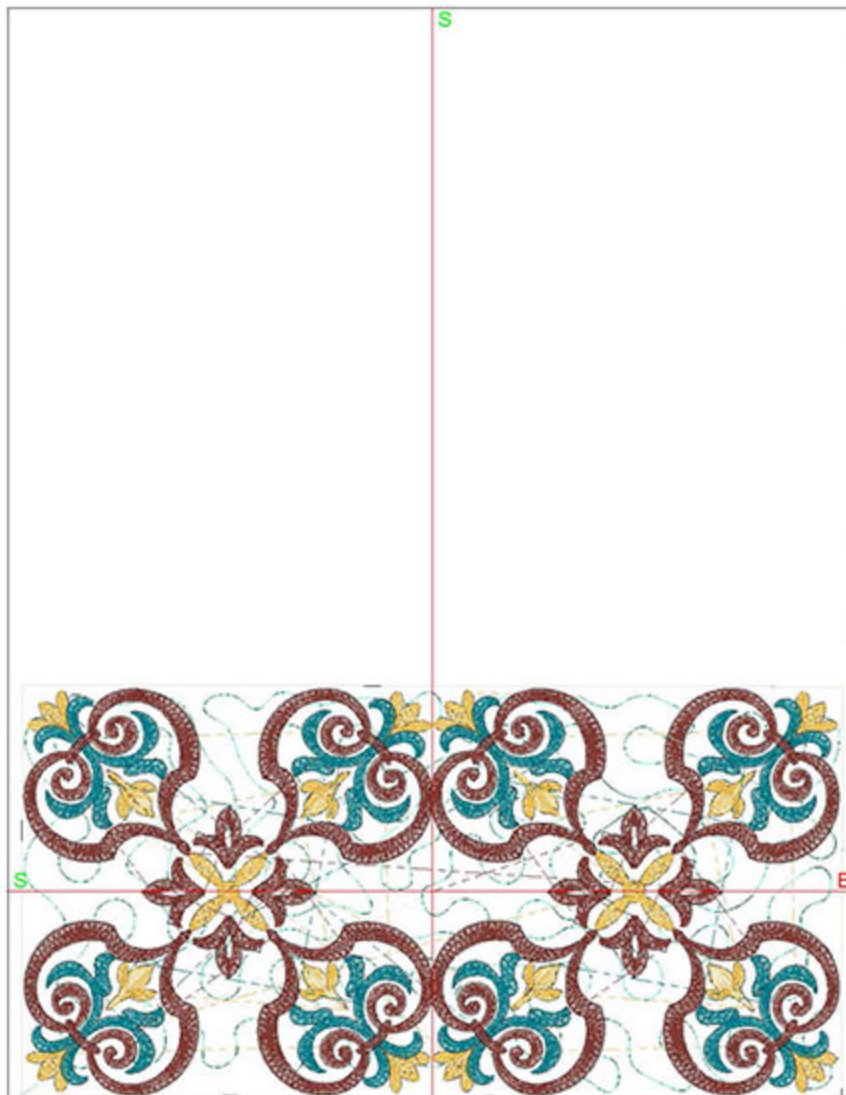

Name: MTQBlock8\_4x8.ART

Height: 100.4 mm  
 Width: 199.8 mm  
 Stitches: 29762  
 Colors: 5  
 Color changes: 4  
 Trims: 44  
 Machine format: Bernina  
 Hoop: Designer Royal (360 x 200)  
 Total bobbin: 52.34m

Color Sequence:

| #  | Color | Code | Name                 | Chart            |
|----|-------|------|----------------------|------------------|
| 1. | 1     | 1682 | Tusk                 | Madeira Polyneon |
| 2. | 17    | 17   | Turquoise            | Default          |
| 3. | 4     | 1771 | Whipped Butterscotch | Madeira Polyneon |
| 4. | 3     | 1890 | Midnight Green       | Madeira Polyneon |
| 5. | 5     | 1858 | Chestnut             | Madeira Polyneon |

Machine runtime:

| Module  | Runtime (hr:min:sec) |
|---------|----------------------|
| Default | 1:17:15              |



## Design Worksheet

BERNINA Embroidery Software DesignerPlus

Design: MTQBlock9\_4x4

Stitches: 9618

Colors: 4

Height: 99.8 mm

Width: 99.5 mm

Zoom: 0.64

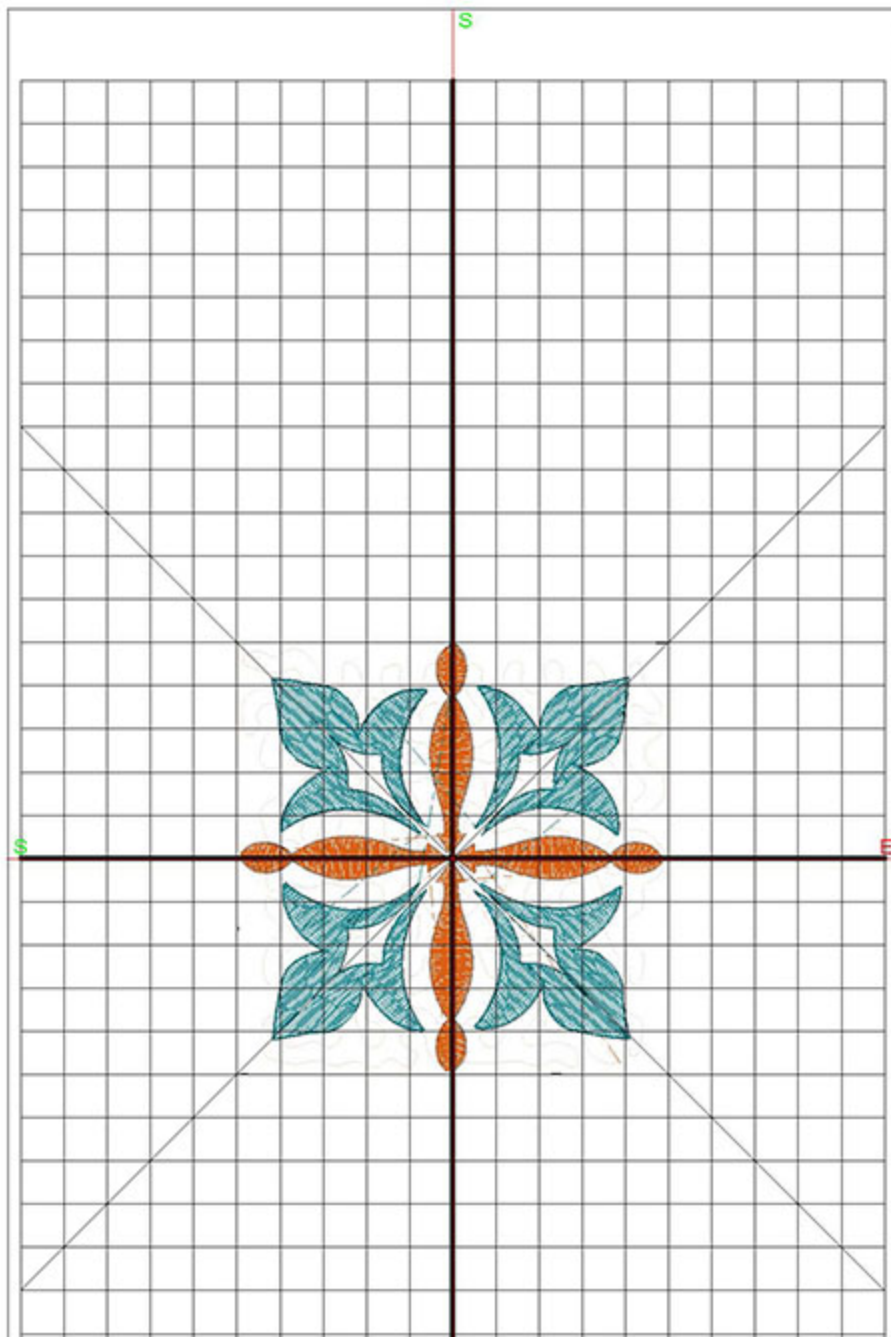

Total bobbin: 19.84m

Color Film:

| #  | Chart | Code | Name           | Thread |
|----|-------|------|----------------|--------|
| 1. |       | 1682 | Tusk           | 1.01m  |
| 2. |       | 1682 | Tusk           | 5.72m  |
| 3. |       | 1621 | Rust           | 15.88m |
| 4. |       | 1890 | Midnight Green | 30.11m |

Machine runtime: 0:16:02





Design Worksheet

Zoom: 1.21

BERNINA Embroidery  
Software DesignerPlus

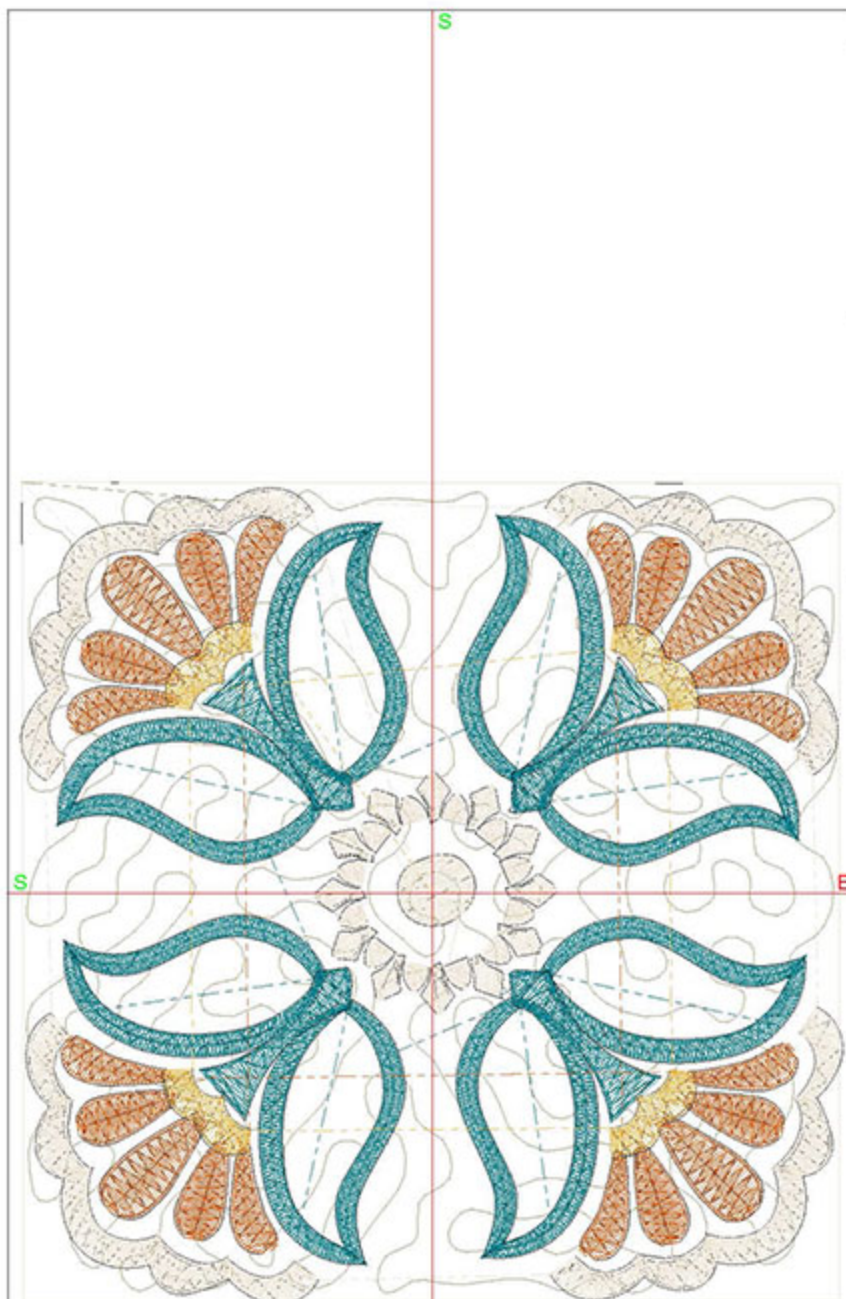

Name: MTQBlock10\_4x4.ART  
 Height: 100.1 mm  
 Width: 100.0 mm  
 Stitches: 14472  
 Colors: 5  
 Color changes: 5  
 Trims: 54  
 Machine format: Bernina  
 Hoop: BERNINA E16 9cm - 3.51in Round  
 Total bobbin: 29.22m

Color Sequence:

| #  | Color | Code | Name                 | Chart            |
|----|-------|------|----------------------|------------------|
| 1. | 1     | 1682 | Tusk                 | Madeira Polyneon |
| 2. | 19    | 19   | Khaki                | Default          |
| 3. | 1     | 1682 | Tusk                 | Madeira Polyneon |
| 4. | 4     | 1890 | Midnight Green       | Madeira Polyneon |
| 5. | 2     | 1621 | Rust                 | Madeira Polyneon |
| 6. | 5     | 1771 | Whipped Butterscotch | Madeira Polyneon |

Machine runtime:  

| Module  | Runtime (hr:min:sec) |
|---------|----------------------|
| Default | 0:45:48              |



Design Worksheet

Zoom: 1.20

BERNINA Embroidery  
Software DesignerPlus

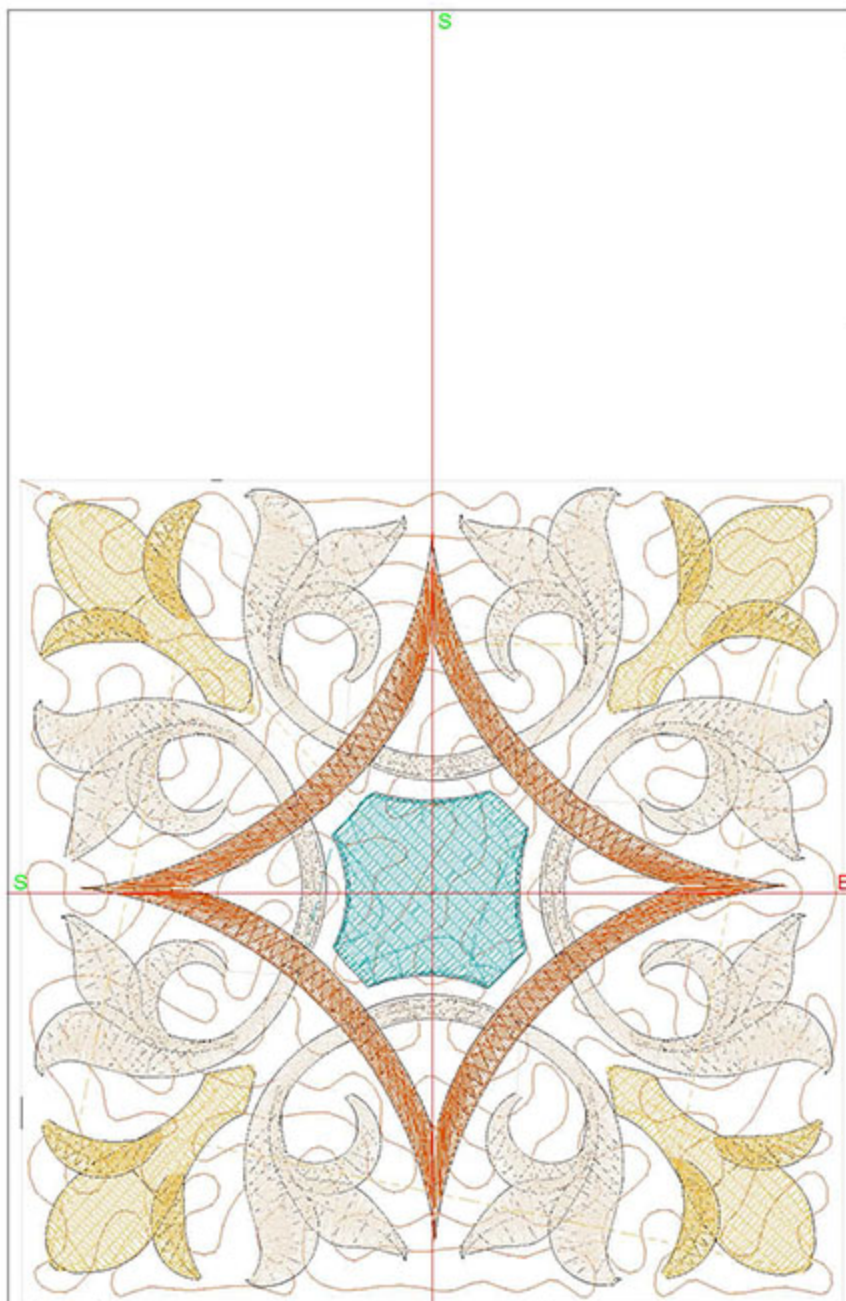

Name: MTQBlock11\_4x4.ART

Height: 101.0 mm  
 Width: 100.5 mm  
 Stitches: 12643  
 Colors: 4  
 Color changes: 5  
 Trims: 25  
 Machine format: Bernina  
 Hoop: Designer Royal (360 x 200)  
 Total bobbin: 30.64m

Color Sequence:

| #  | Color | Code | Name                 | Chart            |
|----|-------|------|----------------------|------------------|
| 1. |       | 1682 | Tusk                 | Madeira Polyneon |
| 2. |       | 1621 | Rust                 | Madeira Polyneon |
| 3. |       | 1682 | Tusk                 | Madeira Polyneon |
| 4. |       | 1888 | Deep Sky Blue        | Madeira Polyneon |
| 5. |       | 1621 | Rust                 | Madeira Polyneon |
| 6. |       | 1771 | Whipped Butterscotch | Madeira Polyneon |

Machine runtime:

| Module  | Runtime (hr:min:sec) |
|---------|----------------------|
| Default | 0:34:49              |



Design Worksheet

Zoom: 1.31

BERNINA Embroidery  
Software DesignerPlus

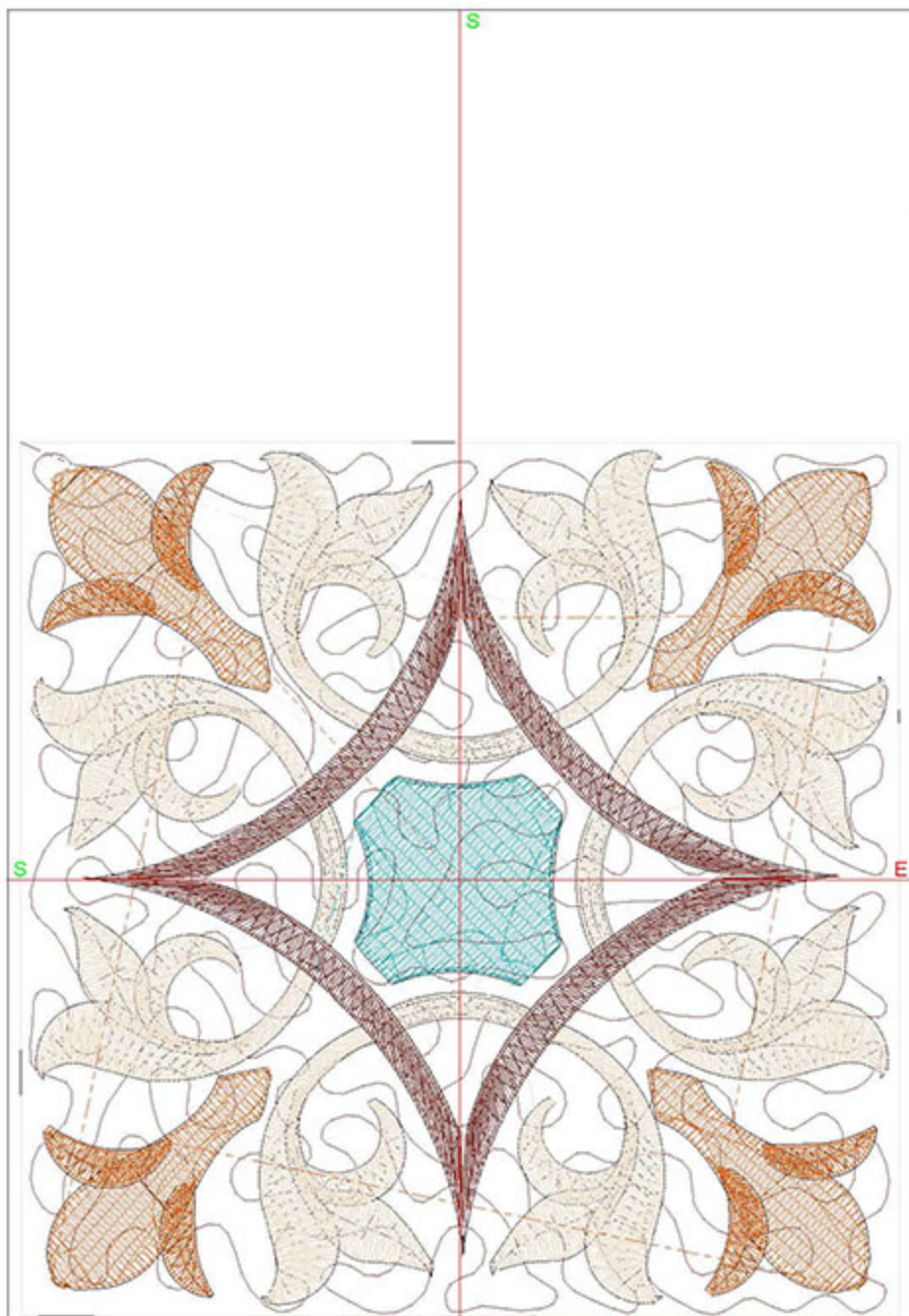

Name: MTQBlock12\_4x4.ART

Height: 100.1 mm  
Width: 100.5 mm  
Stitches: 14650  
Colors: 4  
Color changes: 5  
Trims: 18  
Machine format: Bernina  
Hoop: Designer Royal (360 x 200)  
Total bobbin: 34.27m

Color Sequence:

| #  | Color | Code | Name          | Chart            |
|----|-------|------|---------------|------------------|
| 1. | 1     | 1682 | Tusk          | Madeira Polyneon |
| 2. | 4     | 1858 | Chestnut      | Madeira Polyneon |
| 3. | 1     | 1682 | Tusk          | Madeira Polyneon |
| 4. | 5     | 1888 | Deep Sky Blue | Madeira Polyneon |
| 5. | 4     | 1858 | Chestnut      | Madeira Polyneon |
| 6. | 2     | 1621 | Rust          | Madeira Polyneon |

Machine runtime:

| Module  | Runtime (hr:min:sec) |
|---------|----------------------|
| Default | 0:37:37              |