

■ 1. Mad-P:1860 ■ 10.Mad-P:1622
 ■ 2. Mad-P:1802 ■ 11.Mad-P:1803
 ■ 3. Mad-P:1802 ■ 12.Mad-P:1802
 ■ 4. Mad-P:1803 ■ 13.Mad-P:1803
 ■ 5. Mad-P:1803 ■ 14.Mad-P:1941
 ■ 6. Mad-P:1803 ■ 15.Mad-P:1804
 ■ 7. Mad-P:1803 ■ 16.Mad-P:1915
 ■ 8. Mad-P:1886 ■ 17.Mad-P:1622
 ■ 9. Mad-P:1803

Gfe-Bea-4-1.vp3
 7.74x11.70 inches; 40,363 stitches
 17 thread changes; 8 colors



■ 1. Mad-P:1802 ■ 8. Mad-P:1886
 ■ 2. Mad-P:1860 ■ 9. Mad-P:1802
 ■ 3. Mad-P:1804 ■ 10.Mad-P:1803
 ■ 4. Mad-P:1886 ■ 11.Mad-P:1803
 ■ 5. Mad-P:1803 ■ 12.Mad-P:1915
 ■ 6. Mad-P:1622 ■ 13.Mad-P:1622
 ■ 7. Mad-P:1804

Gfe-Bea-4-10.vp3
 3.67x11.62 inches; 26,291 stitches
 13 thread changes; 7 colors

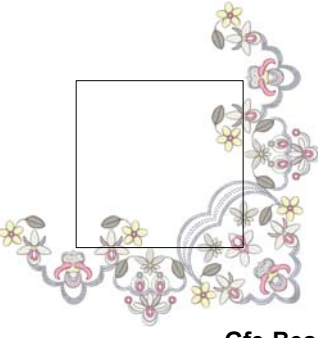

■ 1. Mad-P:1802
 ■ 2. Mad-P:1860
 ■ 3. Mad-P:1886
 ■ 4. Mad-P:1804
 ■ 5. Mad-P:1803
 ■ 6. Mad-P:1886
 ■ 7. Mad-P:1802
 ■ 8. Mad-P:1804
 ■ 9. Mad-P:1622
 ■ 10.Mad-P:1803
 ■ 11.Mad-P:1803
 ■ 12.Mad-P:1915
 ■ 13.Mad-P:1622

Gfe-Bea-4-11.vp3
 7.61x7.61 inches; 23,323 stitches
 13 thread changes; 7 colors



■ 1. Mad-P:1803 ■ 8. Mad-P:1886
 ■ 2. Mad-P:1803 ■ 9. Mad-P:1802
 ■ 3. Mad-P:1860 ■ 10.Mad-P:1804
 ■ 4. Mad-P:1886 ■ 11.Mad-P:1941
 ■ 5. Mad-P:1803 ■ 12.Mad-P:1915
 ■ 6. Mad-P:1622 ■ 13.Mad-P:1622
 ■ 7. Mad-P:1803

Gfe-Bea-4-12.vp3
 6.90x11.18 inches; 23,175 stitches
 13 thread changes; 8 colors

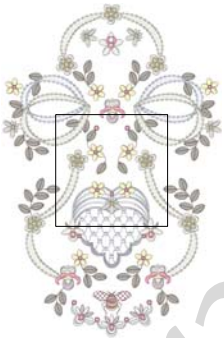

■ 1. Mad-P:1860 ■ 10.Mad-P:1803
 ■ 2. Mad-P:1886 ■ 11.Mad-P:1941
 ■ 3. Mad-P:1802 ■ 12.Mad-P:1803
 ■ 4. Mad-P:1802 ■ 13.Mad-P:1804
 ■ 5. Mad-P:1803 ■ 14.Mad-P:1886
 ■ 6. Mad-P:1803 ■ 15.Mad-P:1802
 ■ 7. Mad-P:1886 ■ 16.Mad-P:1915
 ■ 8. Mad-P:1803 ■ 17.Mad-P:1622
 ■ 9. Mad-P:1622

Gfe-Bea-4-2.vp3
 7.63x11.69 inches; 50,506 stitches
 17 thread changes; 8 colors



■ 1. Mad-P:1802 ■ 8. Mad-P:1802
 ■ 2. Mad-P:1860 ■ 9. Mad-P:1804
 ■ 3. Mad-P:1886 ■ 10.Mad-P:1803
 ■ 4. Mad-P:1803 ■ 11.Mad-P:1941
 ■ 5. Mad-P:1803 ■ 12.Mad-P:1915
 ■ 6. Mad-P:1622 ■ 13.Mad-P:1622
 ■ 7. Mad-P:1886

Gfe-Bea-4-3.vp3
 5.93x11.27 inches; 37,227 stitches
 13 thread changes; 8 colors



■ 1. Mad-P:1860 ■ 10.Mad-P:1804
 ■ 2. Mad-P:1803 ■ 11.Mad-P:1803
 ■ 3. Mad-P:1803 ■ 12.Mad-P:1941
 ■ 4. Mad-P:1886 ■ 13.Mad-P:1915
 ■ 5. Mad-P:1803 ■ 14.Mad-P:1622
 ■ 6. Mad-P:1622 ■ 15.Mad-P:1803
 ■ 7. Mad-P:1803 ■ 16.Mad-P:1622
 ■ 8. Mad-P:1886 ■ 17.Mad-P:1622
 ■ 9. Mad-P:1802

Gfe-Bea-4-4.vp3
 7.31x11.69 inches; 34,126 stitches
 17 thread changes; 8 colors

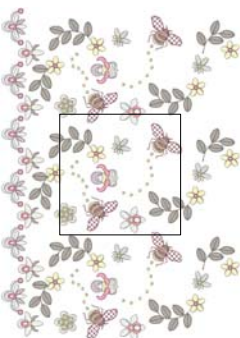

■ 1. Mad-P:1860
 ■ 2. Mad-P:1886
 ■ 3. Mad-P:1803
 ■ 4. Mad-P:1622
 ■ 5. Mad-P:1941
 ■ 6. Mad-P:1802
 ■ 7. Mad-P:1803
 ■ 8. Mad-P:1803
 ■ 9. Mad-P:1804
 ■ 10.Mad-P:1886
 ■ 11.Mad-P:1802
 ■ 12.Mad-P:1915
 ■ 13.Mad-P:1622

Gfe-Bea-4-5.vp3
 7.72x10.83 inches; 43,394 stitches
 13 thread changes; 8 colors



- 1. Mad-P:1802
- 2. Mad-P:1860
- 3. Mad-P:1803
- 4. Mad-P:1803
- 5. Mad-P:1803
- 6. Mad-P:1803
- 7. Mad-P:1886
- 8. Mad-P:1803
- 9. Mad-P:1622
- 10. Mad-P:1803
- 11. Mad-P:1941
- 12. Mad-P:1804
- 13. Mad-P:1886
- 14. Mad-P:1802
- 15. Mad-P:1915
- 16. Mad-P:1622

Gfe-Bea-4-6.vp3

7.32x11.51 inches; 40,554 stitches
16 thread changes; 8 colors

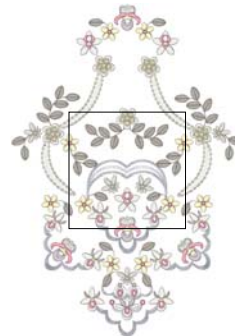

- 1. Mad-P:1802
- 2. Mad-P:1860
- 3. Mad-P:1804
- 4. Mad-P:1803
- 5. Mad-P:1803
- 6. Mad-P:1886
- 7. Mad-P:1803
- 8. Mad-P:1622
- 9. Mad-P:1803
- 10. Mad-P:1886
- 11. Mad-P:1802
- 12. Mad-P:1804
- 13. Mad-P:1803
- 14. Mad-P:1915
- 15. Mad-P:1622

Gfe-Bea-4-7.vp3

7.74x11.23 inches; 43,497 stitches
15 thread changes; 7 colors



- 1. Mad-P:1802
- 2. Mad-P:1860
- 3. Mad-P:1802
- 4. Mad-P:1802
- 5. Mad-P:1803
- 6. Mad-P:1803
- 7. Mad-P:1802
- 8. Mad-P:1802
- 9. Mad-P:1886
- 10. Mad-P:1803
- 11. Mad-P:1622
- 12. Mad-P:1886
- 13. Mad-P:1802
- 14. Mad-P:1804
- 15. Mad-P:1803
- 16. Mad-P:1802
- 17. Mad-P:1803
- 18. Mad-P:1941
- 19. Mad-P:1915
- 20. Mad-P:1882

Gfe-Bea-4-8.vp3

7.19x11.70 inches; 54,970 stitches
20 thread changes; 9 colors

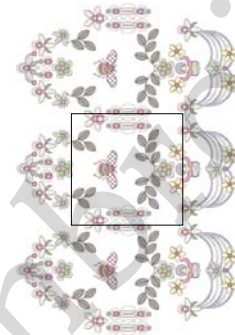

- 1. Mad-P:1802
- 2. Mad-P:1860
- 3. Mad-P:1804
- 4. Mad-P:1886
- 5. Mad-P:1803
- 6. Mad-P:1622
- 7. Mad-P:1886
- 8. Mad-P:1802
- 9. Mad-P:1804
- 10. Mad-P:1803
- 11. Mad-P:1803
- 12. Mad-P:1941
- 13. Mad-P:1915
- 14. Mad-P:1622
- 15. Mad-P:1804
- 16. Mad-P:1803
- 17. Mad-P:1915
- 18. Mad-P:1622

Gfe-Bea-4-9.vp3

7.75x11.73 inches; 61,358 stitches
18 thread changes; 8 colors



- 1. Mad-P:1802
- 2. Mad-P:1860
- 3. Mad-P:1886
- 4. Mad-P:1803
- 5. Mad-P:1622
- 6. Mad-P:1886
- 7. Mad-P:1804
- 8. Mad-P:1803
- 9. Mad-P:1941
- 10. Mad-P:1915
- 11. Mad-P:1622

Gfe-Bea-4-Bonus.vp3

4.21x12.48 inches; 43,992 stitches
11 thread changes; 8 colors